

The Basswood

Width:	123' 0"
Depth:	68' 0"
Bedrooms:	4
Baths:	3 1/2
Main Floor:	3,374 sq. ft. (1,028 sq. meters)
Upper Floor:	1,848 sq. ft. (563 sq. meters)
Total Living:	5,222 sq. ft. (1,591 sq. meters)

Special Notes: 11' plus or minus base wall height, front shed porch roof is insulated, round truss and purlin roof system for front porch upper gabled roof, false purlins included, required steel I-beams to support upper log walls not included, mahogany with leaded glass for two front doors.

BARNA
Log Homes
The experience matters™

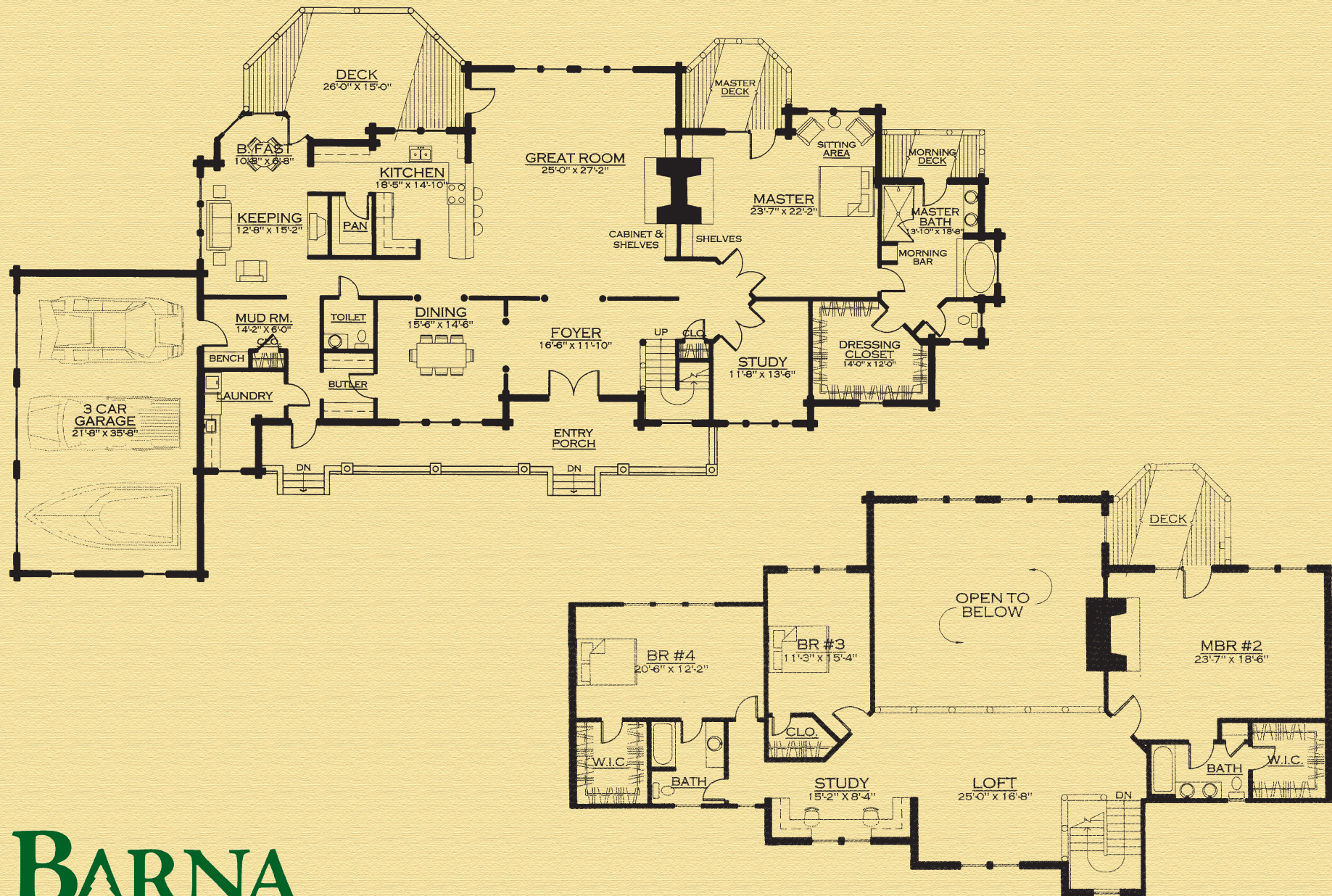

BARNA

Log Homes

The experience matters™